

CMS TEXT

PAGE 1: VAN BUREN PL CLOSED
 PAGE 2: 6-29-17 8AM-NOON
 PAGE 3: USE ALT ROUTES

THE CONTRACTOR SHALL COORDINATE WITH PROPERTY OWNERS FOR TEMPORARY CLOSURE OF DRIVEWAYS LOCATED WITHIN WORK AREA

THE CONTRACTOR SHALL INSTALL DELINEATORS (AT 20' OC MAX) AND SIGNAGE ALONG THE CENTER OF VAN BUREN PLACE AS SHOWN TO TEMPORARILY SPLIT TRAFFIC DURING THIS CLOSURE

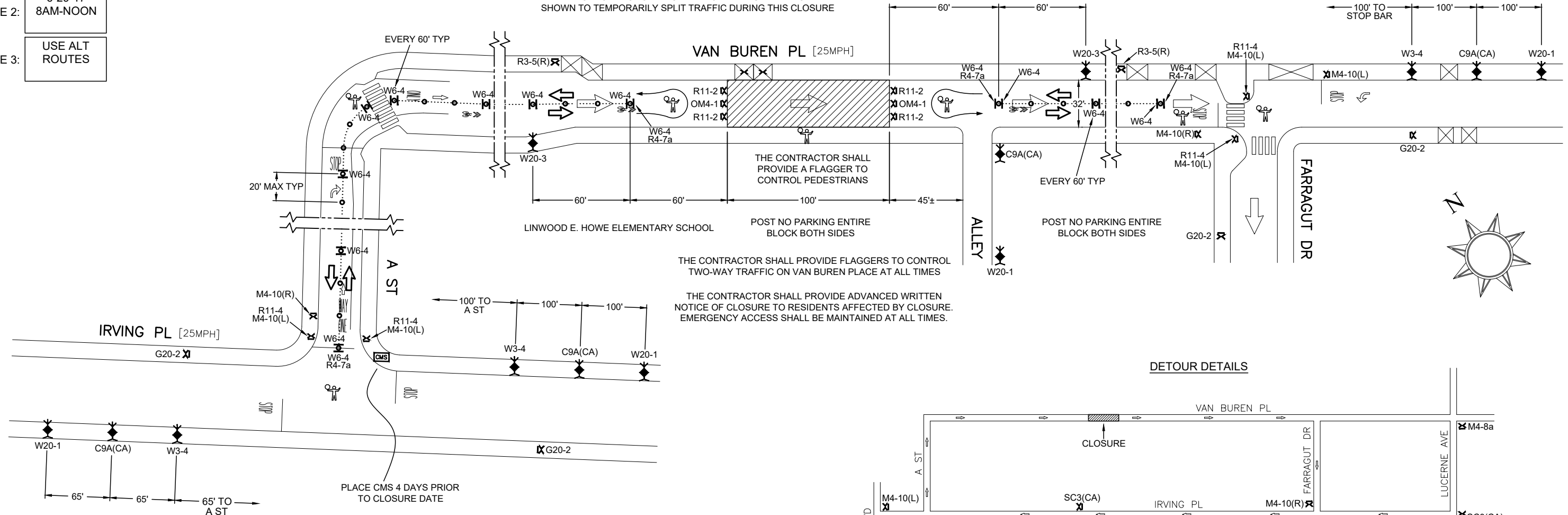

THE CONTRACTOR SHALL PROVIDE A FLAGGER TO CONTROL PEDESTRIANS

POST NO PARKING ENTIRE BLOCK BOTH SIDES

THE CONTRACTOR SHALL PROVIDE FLAGGERS TO CONTROL TWO-WAY TRAFFIC ON VAN BUREN PLACE AT ALL TIMES

THE CONTRACTOR SHALL PROVIDE ADVANCED WRITTEN NOTICE OF CLOSURE TO RESIDENTS AFFECTED BY CLOSURE. EMERGENCY ACCESS SHALL BE MAINTAINED AT ALL TIMES.

DETOUR DETAILS

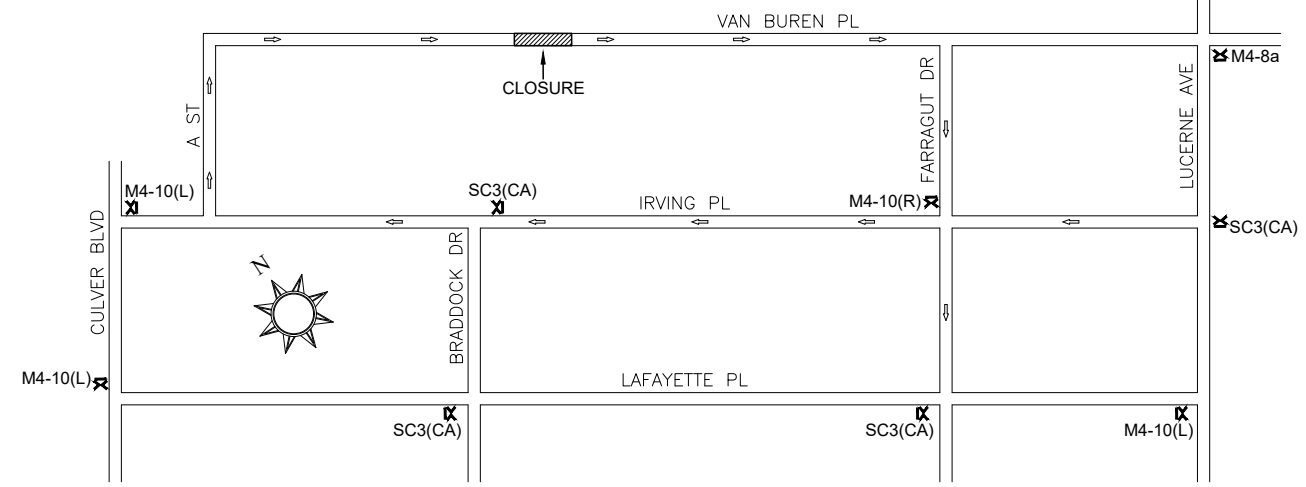

W20-1	C9A(CA)	W3-4	W20-3	R11-4	R11-2	OM4-1	R4-7a	R3-5(R)	W6-4	M4-10(R)	M4-10(L)	SC3(CA)	M4-8a	G20-2

	HIGH LEVEL WARNING DEVICE		FLASHING ARROW BOARD
	TRAFFIC BARRICADE		WORK AREA / CLOSURE
	TRAFFIC BARRICADE WITH SIGN		FLAGGER / T.C.O.
	TRAFFIC CONE / DELINEATOR		DELINEATION CENTERLINE
	DELINEATION-MOUNTED SIGN		TRAFFIC CONTROL SIGN

GENERAL NOTES:

1. ALL SIGNS, DELINEATORS, BARRICADES, AND OTHER TRAFFIC CONTROL DEVICES AND THEIR INSTALLATION SHALL CONFORM TO THE CURRENT EDITION OF THE CALIFORNIA M.U.T.C.D.
2. THE CONTRACTOR SHALL NOTIFY ANY AFFECTED TRANSIT SERVICES AT LEAST THREE WORKING DAYS PRIOR TO CONSTRUCTION ON ANY ROADWAY WHERE BUS SERVICE IS PROVIDED.
3. LOCAL AND EMERGENCY ACCESS SHALL BE MAINTAINED AT ALL TIMES.
4. THE CONTRACTOR SHALL CONTACT THE CITY FOR POSTING OF TEMPORARY NO PARKING SIGNS.

COMPANY / CUSTOMER: BIGGE CRANE
 W/O DATE: 39260 6/26/17
 PROJECT NAME / ADDRESS: 4100 IRVING PL, CULVER CITY
 DATE AND TIME OF PROJECT: 6/29/17 - 8:00 AM TO NOON
 PREPARED BY: ROBERT M
 SCALE: N.T.S.
 SHEET NUMBER: 1 OF 1

PLANS PREPARED BY: **RIGHT OF WAY, INC.**
 150 EAST ARROW HWY
 SAN DIMAS, CA 91773
 P 626.930.9292
 F 626.930.9220
 C-31 NO. 792675
 www.rowtrafficcontrol.com

